

## Big Sky Tower - Build Side Frame

### 1. Lay Out Your Pieces:

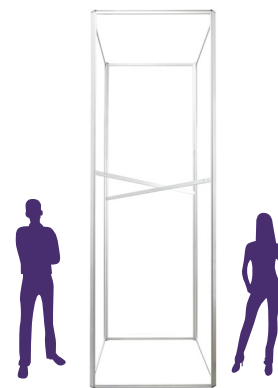

a. We recommend to begin build on flat, soft surface on its side.



b. You'll need 2 people to assemble large frames.

### 2. FOR FRAMES 8 FT or HIGHER or for CUSTOM CUT. Attach Split Connectors to Side Extrusions:

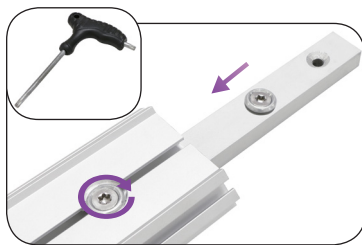

a. Split Connector: Slide into side of 60D extrusion channel that faces the frame's middle. Then attach other extrusion onto the Split Connector. Tighten screws with included **torx key**.

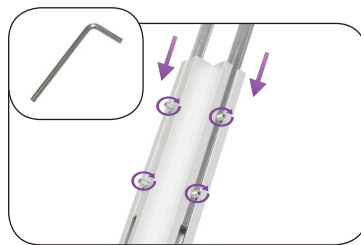
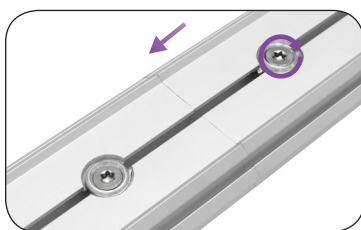

b. Center Locking Bracket: Slide into side of 32D extrusion channel that faces the frame's middle. Then attach other extrusion onto the Center Locking Bracket. Tighten screws with included **2mm allen key**.

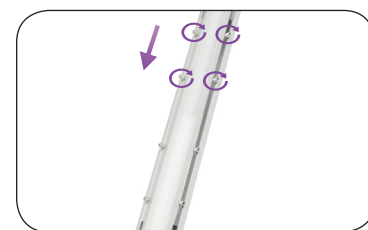

### 3. Locate the Bottom and Side Extrusions:

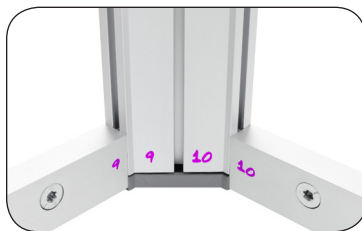

a. See colored numbers on each extrusion piece.

b. Match like colored numbers together. (e.g. 3-3, 4-4).



c. End Lock is already attached to opposite ends of extrusion.

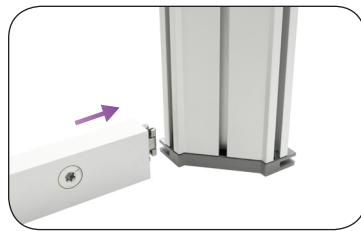

d. Connect horizontal extrusion to the bottom of a vertical extrusion, screw facing inward.



e. Connect bottom extrusions together and use **torx key** to tighten.

## Next - Build the Top Half

### 1. Locate the Top and Side Extrusions:

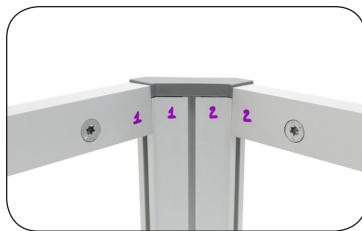

a. See colored numbers on each extrusion piece.

b. Match like colored numbers together. (e.g. 3-3, 4-4).



c. End Lock is already attached to opposite ends of extrusion.

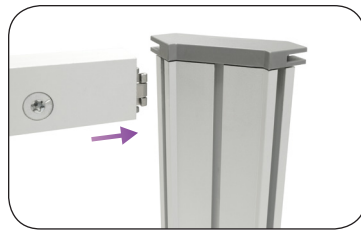

d. Connect horizontal extrusion to the top of a vertical extrusion, screw facing inward.

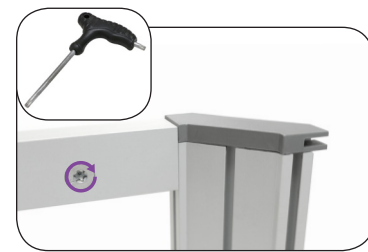

e. Connect the top extrusions together and use **torx key** to tighten.

## Extra Step: Attach Support Strut - FOR FRAMES 8 FT or HIGHER or CUSTOM CUT

### 2. Attach Support Strut to Frame:

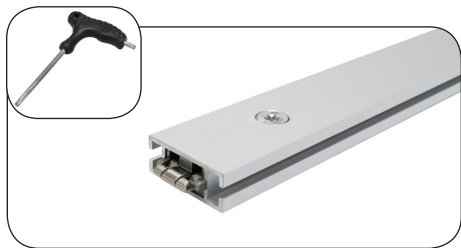

a. End Lock is already attached to opposite ends of Support Strut.

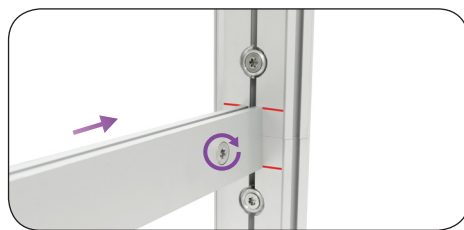

b. Align Support Struts within marked lines, and insert End Lock into top and bottom grooves of frame.

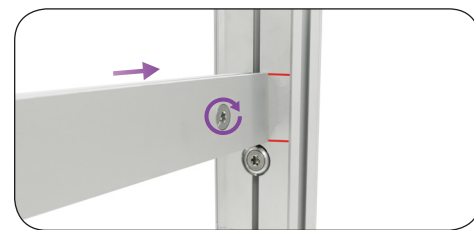

c. Add a second support strut to align marked lines and tighten screws with **torx** key to secure connection.

### 3. Attach Light Hooks :

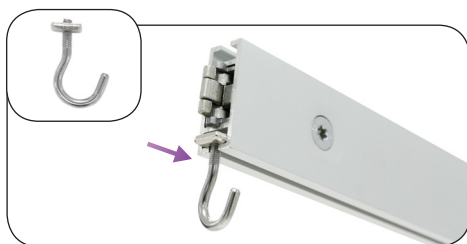

a. Eye Hooks: Insert light hooks into the groove in one end of the extrusion.

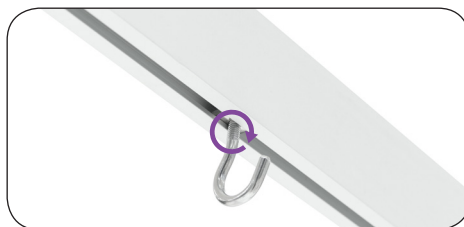

b. Slide the light hooks into the groove and place them in the center. Tighten Hook.

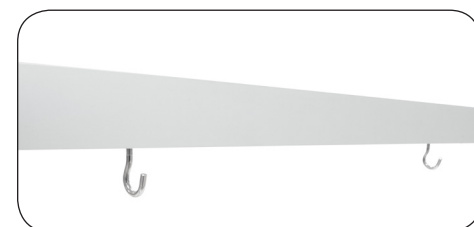

c. Make sure light hooks are place far apart for hooking the LED Ladder Lights.

## Optional Last Step: Ladder Lights Attachment

### 1. Hook Ladder Lights:

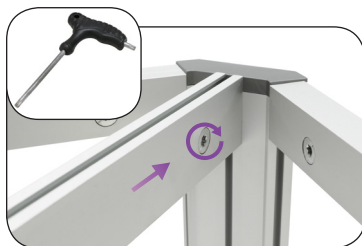

a. Place extrusion with the light hooks on top of the extrusion and connect together.

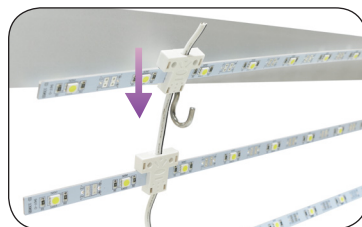

b. Hang ladder LED lights on hooks and drape them down.

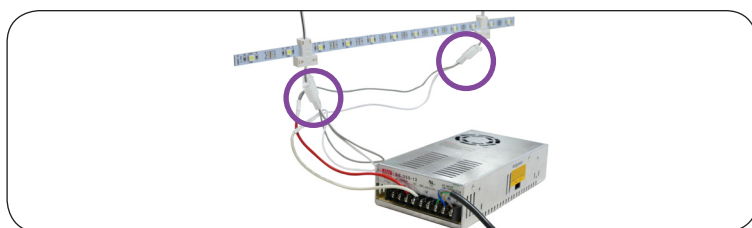

c. The transformer comes pre-wired. Connect the wiring from transformer to the 2 plugs at the bottom of the ladder lights.

