

MODCO 20 - 20X10

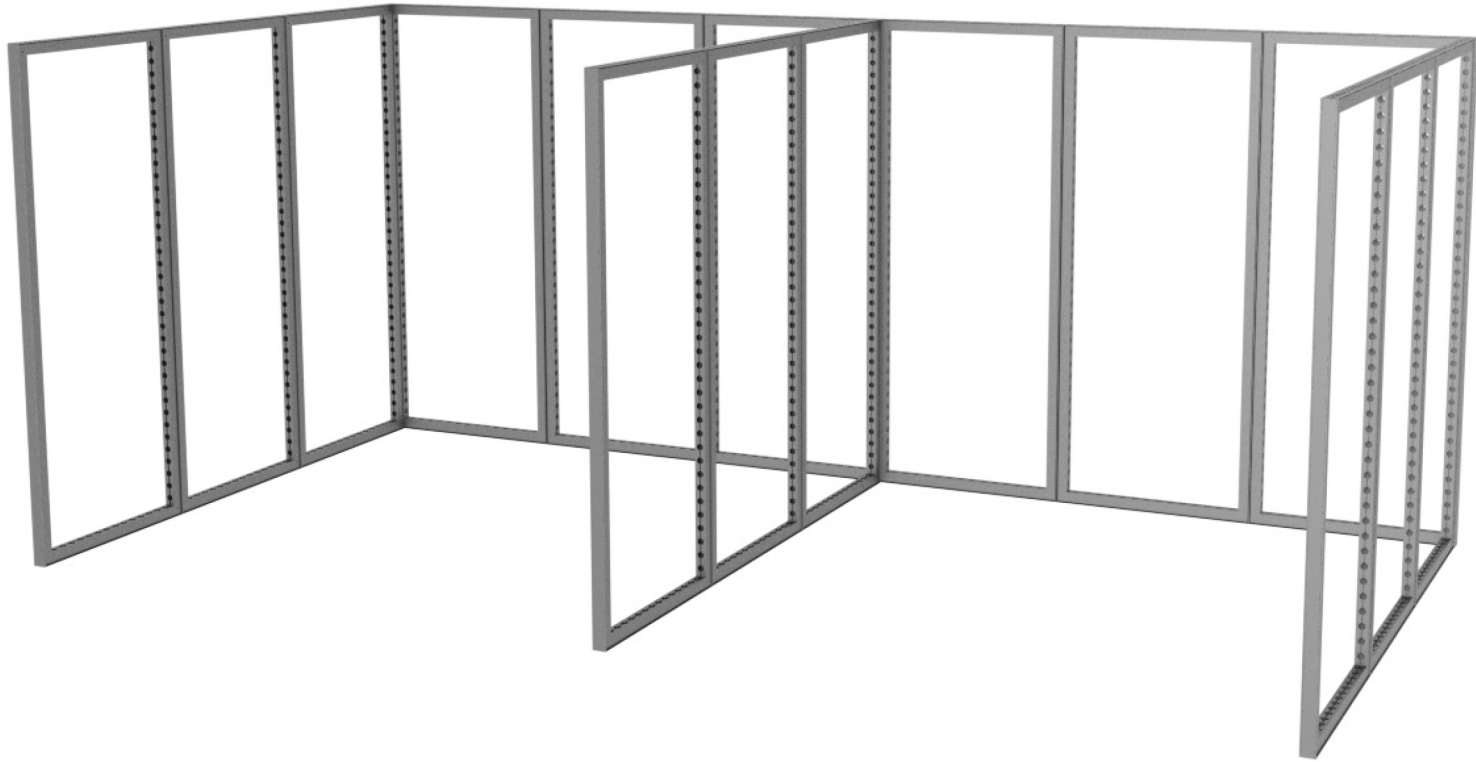

MODCO 20 - 20X10

- Use REF column to reference parts. Build both return walls and the back wall.

Qty.2 - Return Walls

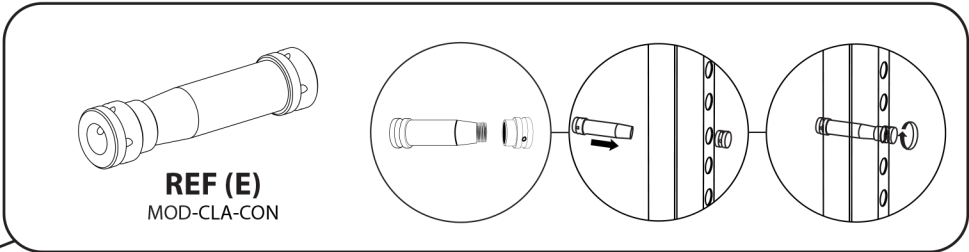
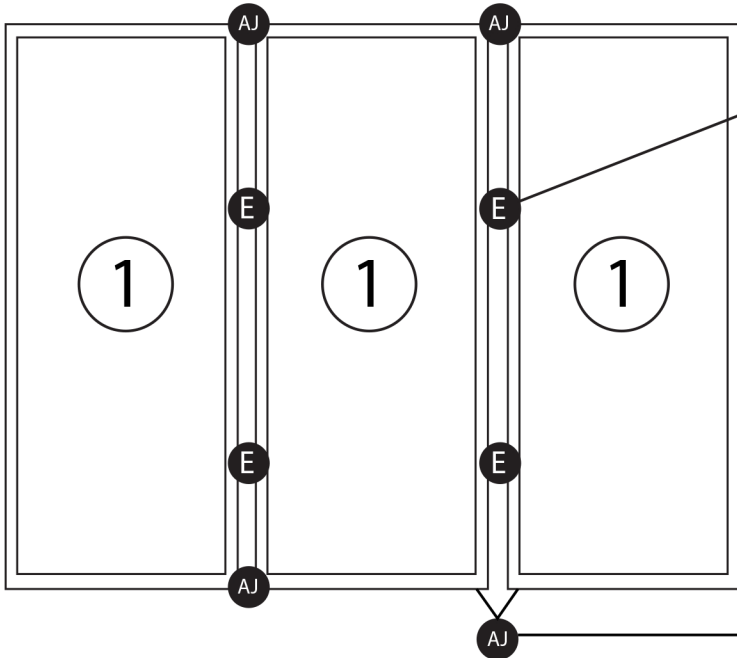

REF (E)
MOD-CLA-CON

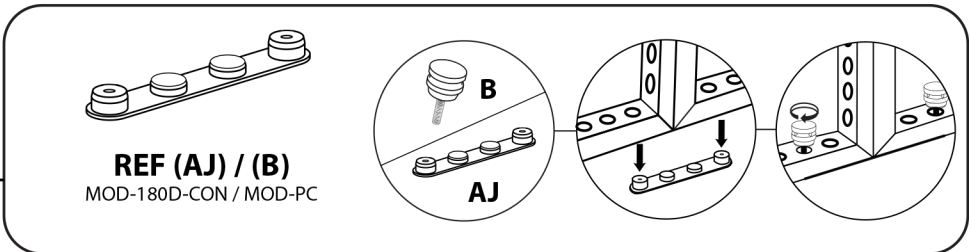

REF (AJ) / (B)
MOD-180D-CON / MOD-PC

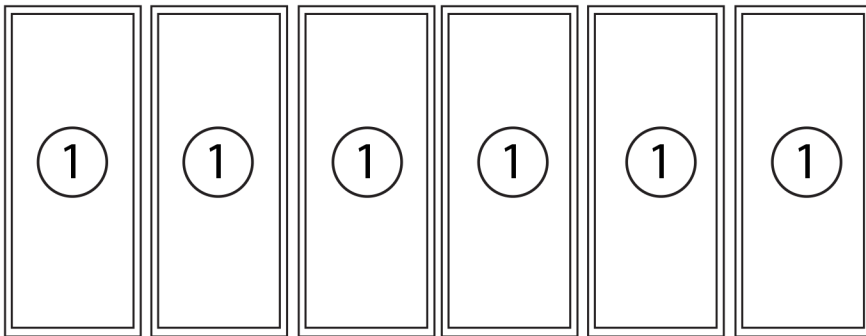

Qty.1 - Back Wall

REF	QTY	PART NO.	DESCRIPTION
1	15	MOD-FRM-992x2418	Straight Frame, Corner Screw Connect 992mm x 2418mm
B	62	MOD-PC	Pin Connector
C	4	MOD-90D-CON	90° Connector
D	4	MOD-SM90D-CON	90° Connector
E	22	MOD-CLA-CON	Clamp Connector
AJ	20	MOD-180D-CON	180 Degree Connector
H	2	MOD-T-90DCON	T Shape 3 Way 90 Degree Connector Used per Set of 2pcs

MODCO 20 - 20X10

- Use REF column to reference parts. Connect returns to backwall.

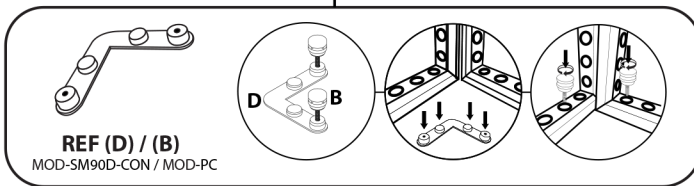
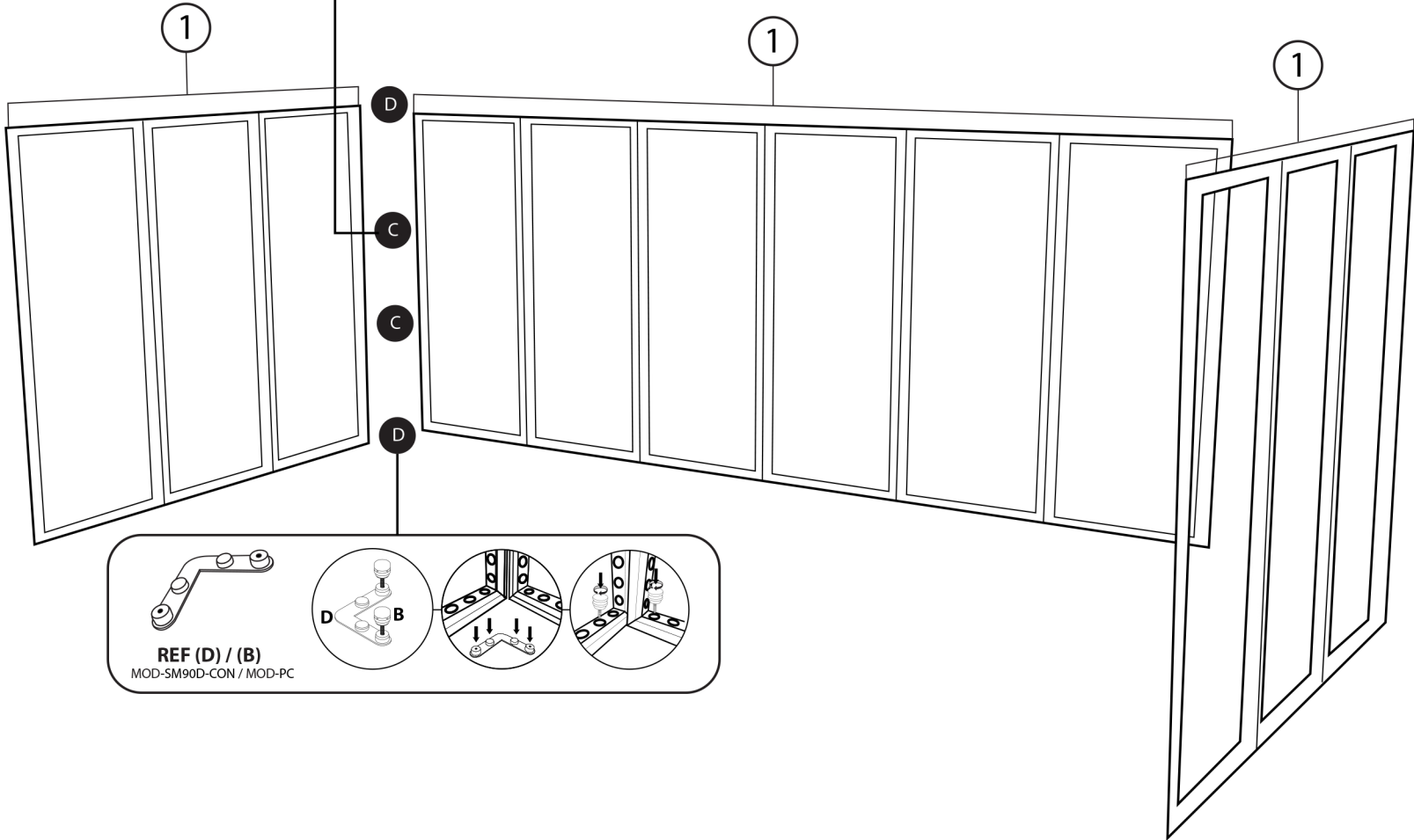
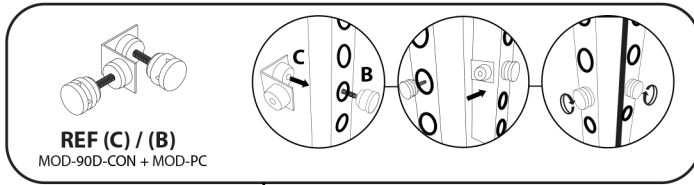

MODCO 20 - 20X10

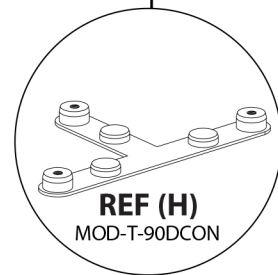
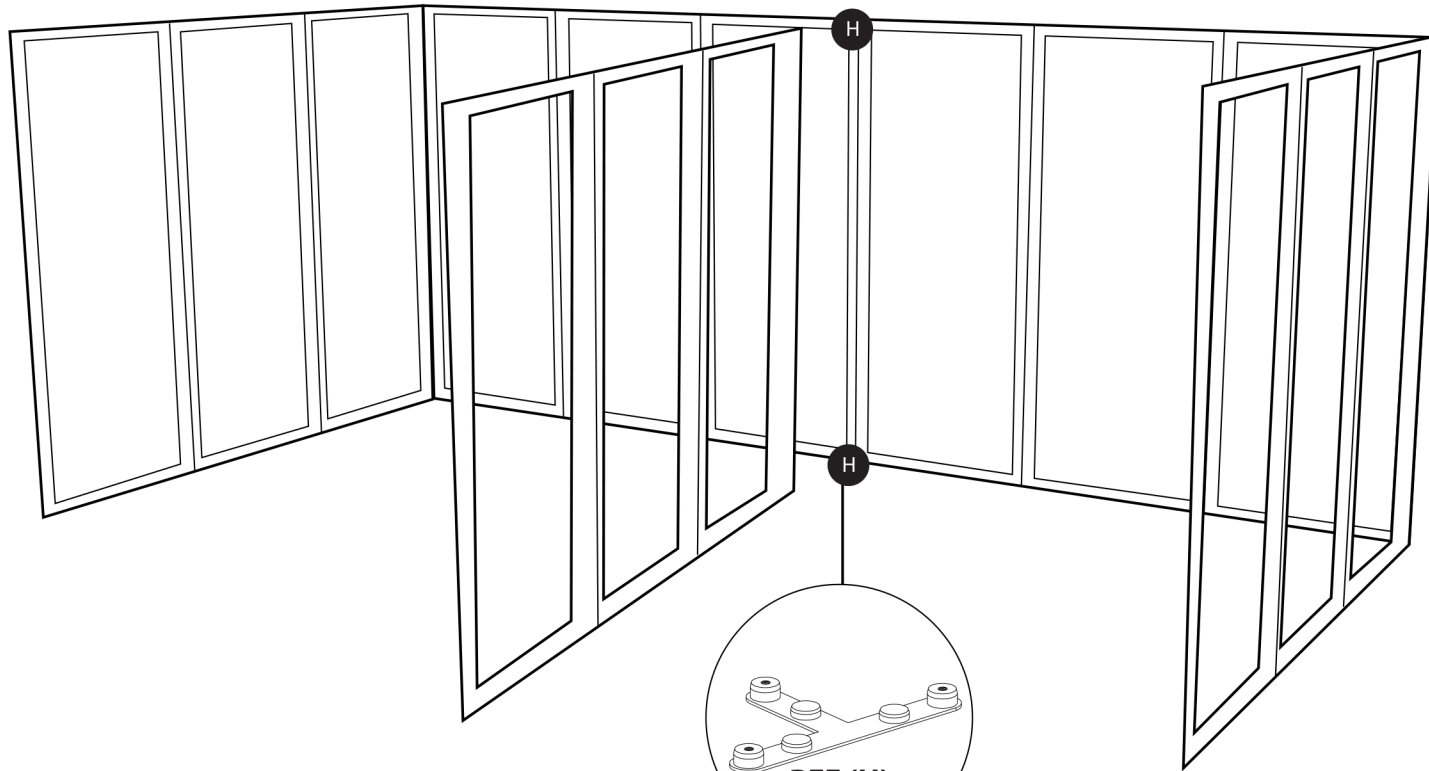

REF (H)
MOD-T-90DCON

MODCO 20 - 20X10

- Use REF column to reference parts. Attach cover profile to each exposed side (4 sides total).

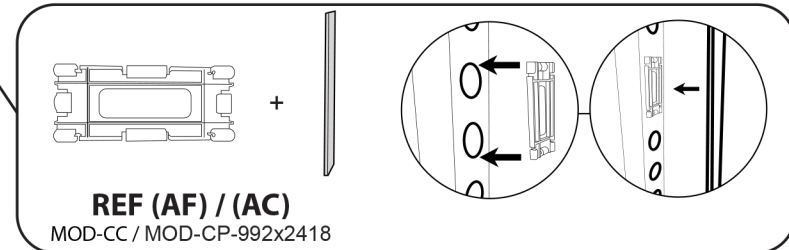
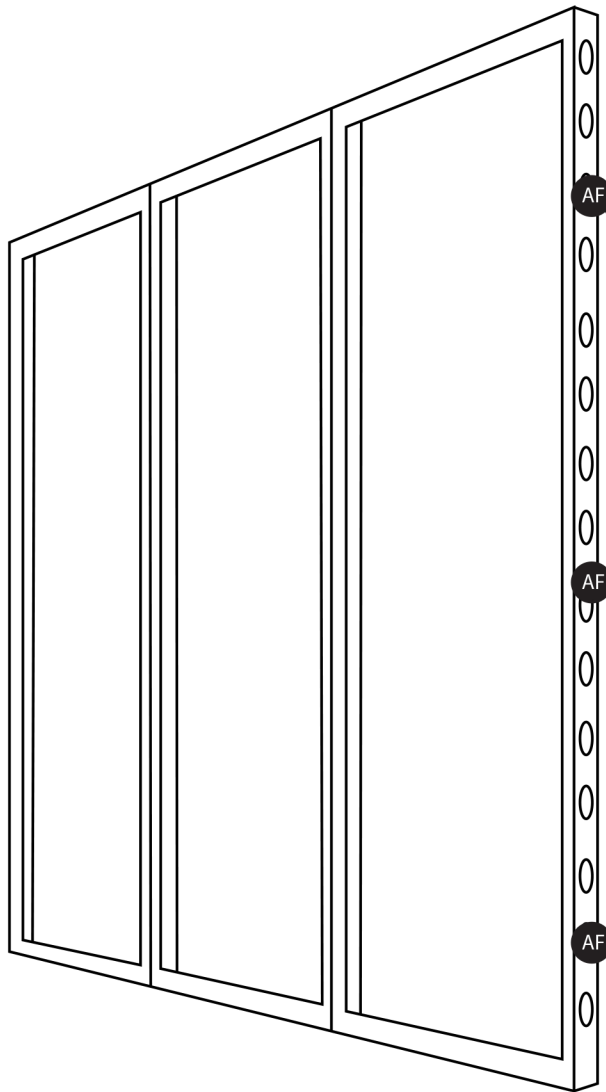

REF	QTY	PART NO.	DESCRIPTION
AC	5	MOD-CP-992x2418	Cover Profile for Frame 992x2418. Flat Model. Anodized
AF	15	MOD-CC	Clip Connector Cover Connects Cover Profile
AL	60	MOD-FP	Modco Frame Protector

GRAPHIC INSTALL



Place graphic over the front of the frame.



Begin inserting SEG beading at each corner.

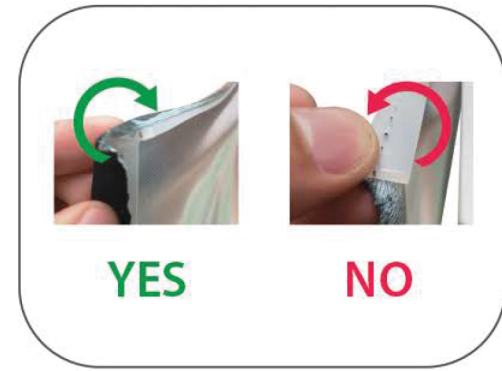

Insert the silicone beading with the fabric folded over. The silicone beading should not be exposed.

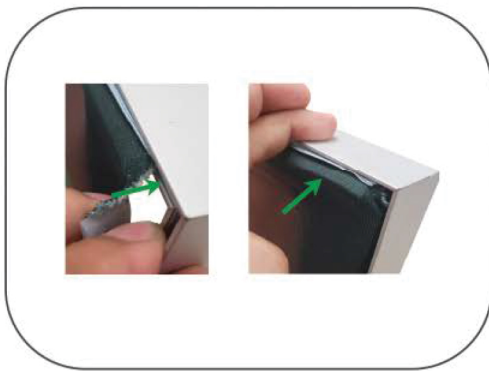

Using your fingers, push both fabric and silicone beading completely into the extrusions channel.



Continue to push in the remaining silicone beading on each side.

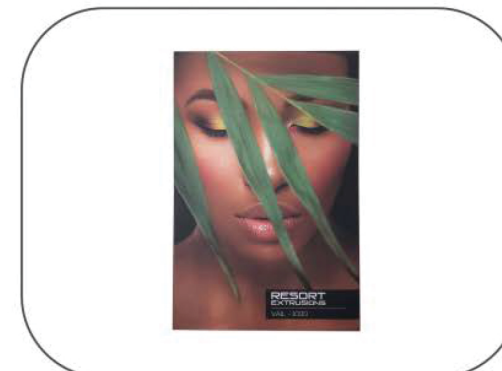

Check the perimeter of the frame for any excess beading that hasn't been pushed in. Graphic should be taut.