

Breakaway Banner

BRKAWAY-POLES

Breakaway Banners are an interactive way to represent your team and brand enthusiastically! Breakaway Banners are custom-printed vinyl graphics with hook & loop down the middle to create a breakaway action. Ideal for youth, high school and college football games. Parents or teammates hold the upright poles on either side, while the hook & loop strip allows the team to break through the middle of the banner as they run onto the field. Breakaway Banners are made of durable 13 oz. vinyl and are designed to be re-used.



features and benefits:

- 30mm anodized silver poles
- Poles are easy to assemble due to the tool-less snap button connections
- Includes a canvas carry bag

- Custom graphic will feature a 3" pole pocket on the left + right sides, hook & loop graphic connection down center + opening on the sides to create firm pole grips
- Lifetime hardware warranty against manufacturer defects

dimensions:

Hardware

Graphic

(When all 4 poles are assembled)

102"hx 1.18"d
2590mm(h) x 30mm(d)

Approximate weight:
5 lb / 3 kg

Refer to related graphic template for more information.

One year warranty

Finished Graphic Sizes:

Small - 96" w x 48" h [BRKAWAY-SM-G]

Medium - 116.5" w x 96" h [BRKAWAY-M-G]

Large - 144" w x 96" h [BRKAWAY-LG-G]

Shipping

Visit:

<https://www.theexhibitorshandbook.com/download-graphic-templates>

Packing case(s):
1-HZ-S-BX

Shipping dimensions:

Small - 37"l x 25"h x 4"d

939mm(l) x 635mm(h) x 609mm(d)

Approximate total shipping weight: 10 lb / 5 kg

Medium - 37"l x 25"h x 4"d

939mm(l) x 635mm(h) x 609mm(d)

Approximate total shipping weight: 15 lb / 7 kg

Large - 37"l x 25"h x 4"d

939mm(l) x 635mm(h) x 609mm(d)

Approximate total shipping weight: 17 lb / 8 kg

additional information:

Graphic material:
13 oz. Scrim

When included in a larger order, a different packaging solution will be provided to accommodate all contents of the order. Individual packaging may no longer be provided.



This product may include the following materials for recycle:
aluminum, select wood, fabric, cardboard, paper, steel, and plastics.

Custom Graphic Sold Separately

We are continually improving and modifying our product range and reserve the right to vary the specifications without prior notice. All dimensions and weights quoted are approximate and we accept no responsibility for variance. E&OE. See Graphic Templates for graphic bleed specifications.

Included In Your Kit

Exploded View

Components, Connectors & Graphics



25.5" LONG 30MM TUBE WITH SWAGE x6

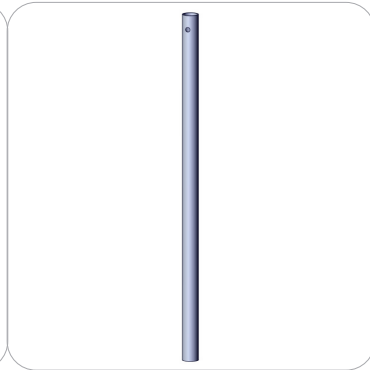

25.5" LONG 30MM TUBE x2

Top Tubes 3 and 6 and Bottom Tubes 1 and 4.

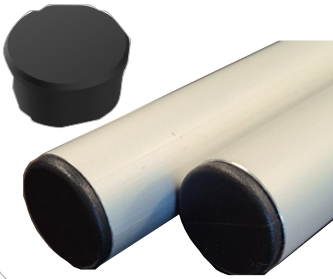

CPTRI30 x4



STRAPS SECURE TUBES TOGETHER FOR PACKING

HL-STRAP-480 x2



HZ-S-BG x1

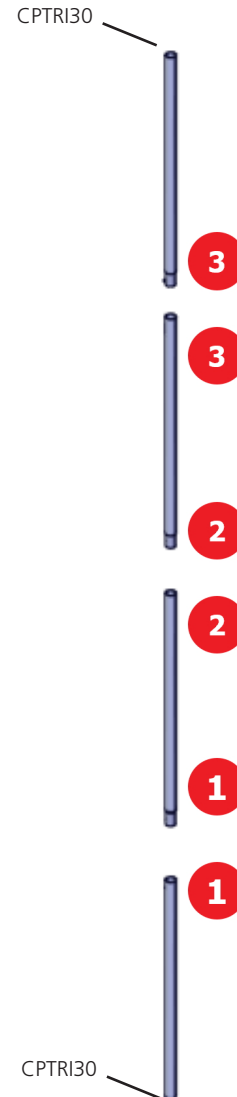

Right Side

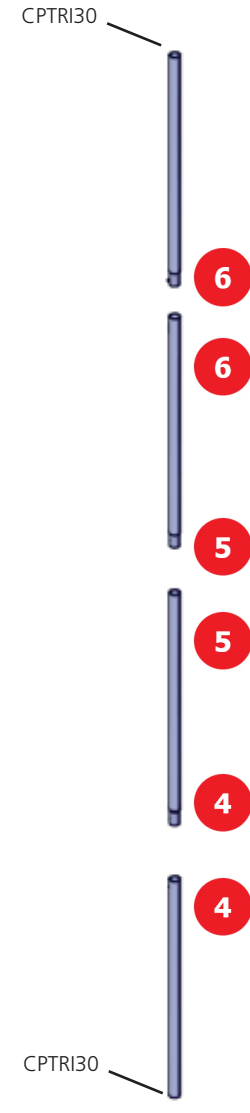

Left Side

Kit Assembly

Step by Step

Step 1.

Connect tubes by matching number to number labels. Repeat this process for both right & left pole assembly.

Reference Connection Method(s) 1 for more details.

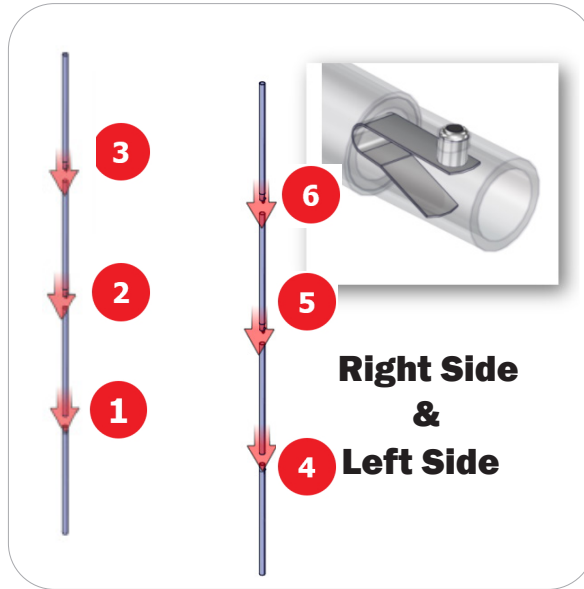
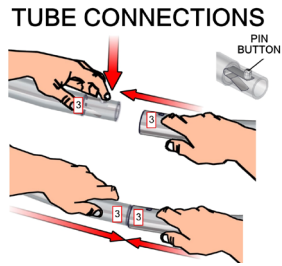

Step 2.

Install right & left poles into designated pole pockets. Top of pocket will be closed to prevent pole from sliding through.

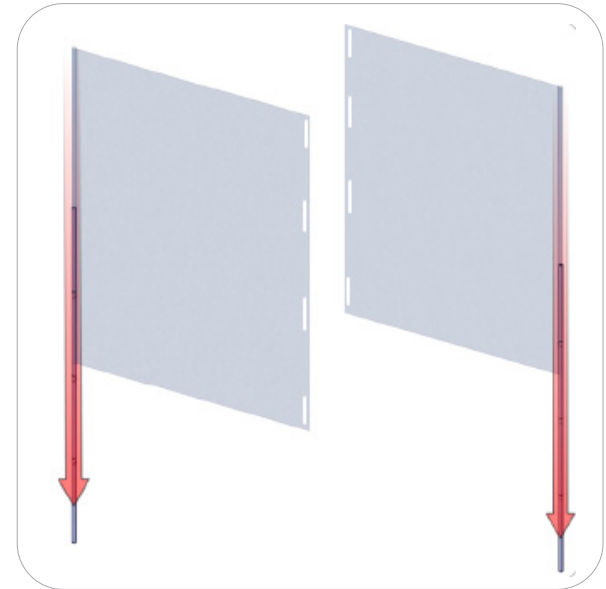

Step 3.

Attach the two banners together with the corresponding hook & loop strips that run down the middle of each banner piece. This will complete assembly. The custom graphics will have holes cut for pole grip.

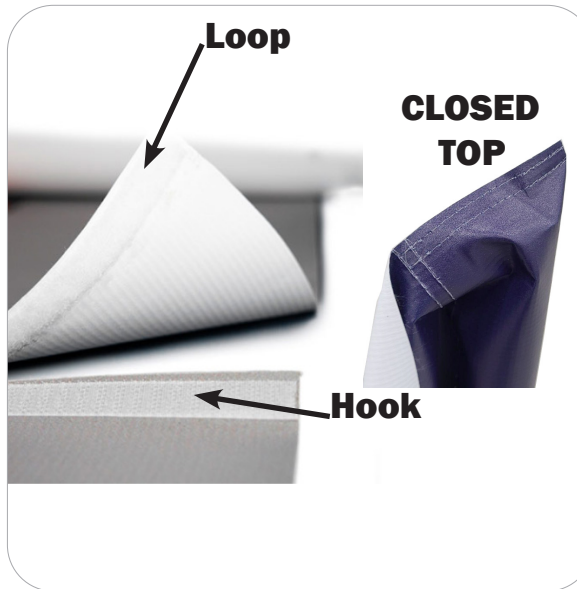

Step 4. Optional

Poles can be used at half height. Just follow connection methods. Match number to number as shown. Repeat step 2 & 3 for graphic mounting. Use poles with caps for the small graphic setup.

Reference Connection Method(s)

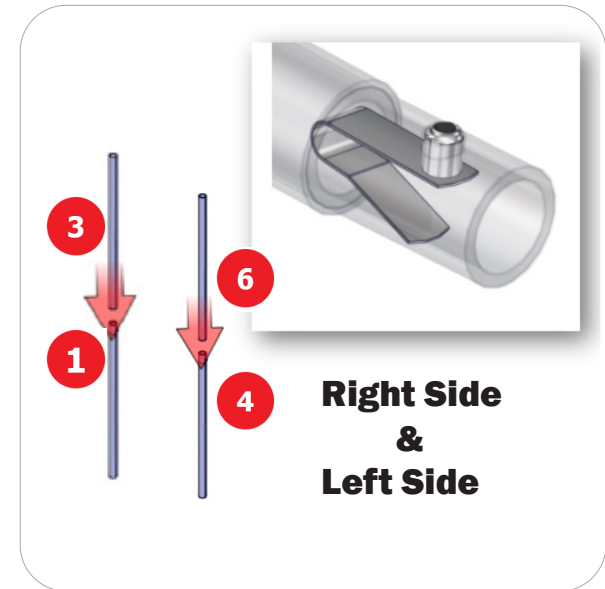
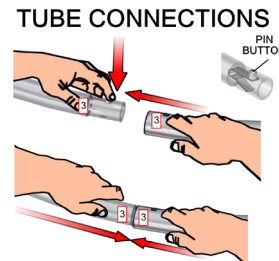

Connection Methods

Connection Method 1: SNAP BUTTON

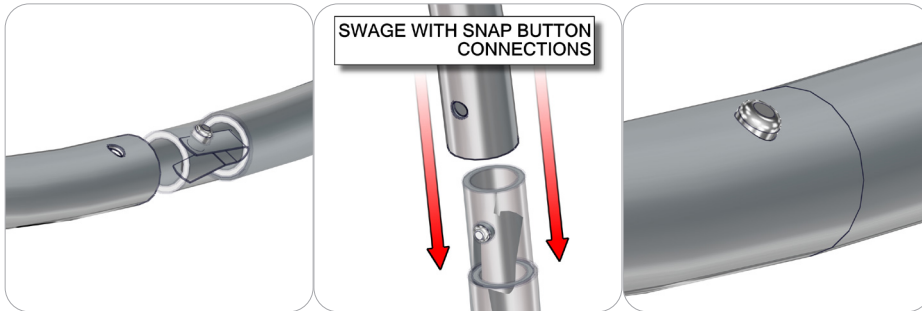

Take the plastic connector and make sure the snap buttons are in proper position for the frame tube holes. Simply press the snap button with your thumb and carefully slide the tube onto the connector. The snap button should pop through. Some twisting may be necessary to assure the snap button has popped all the way through the tube hole. Do not force the connection and be careful with the tube edges, they may be sharp.
