

Big Sky Counter - Build From Bottom Up

1. Lay Out Your Pieces:

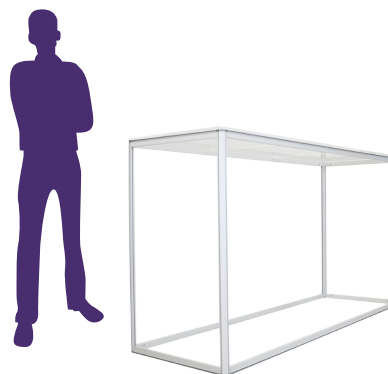

a. We recommend to begin build on flat, soft surface.



b. 1 person can assemble large frames.

2. Locate the Bottom and Side Extrusions:

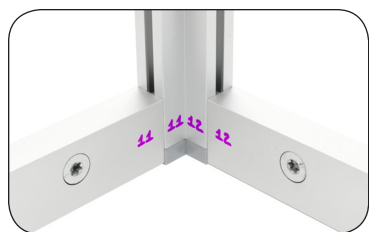

a. See colored numbers on each extrusion piece.
b. Match like colored numbers together. (e.g. 3-3, 4-4).



c. End Lock is already attached to opposite ends of extrusion.

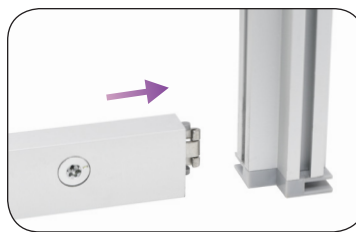

d. Connect horizontal extrusion to the bottom of a vertical extrusion, screw facing inward.



e. Use **Torx Key** to tighten and secure connection.

3. FOR FRAMES 8 FT or WIDER or for CUSTOM CUT. Attach Split Connectors to Bottom & Top Extrusions:

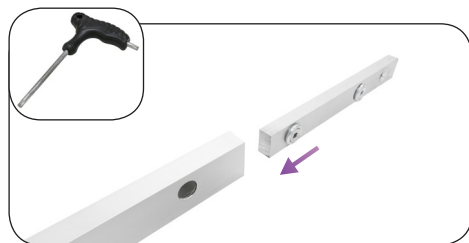

a. **Split Connector**: Remove the screw and insert split connector into one end of the extrusion.

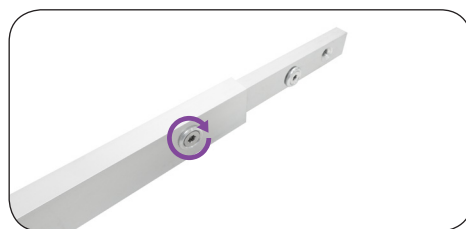

b. Tighten screw to lock it into place. Remove the remaining screw from the connector.

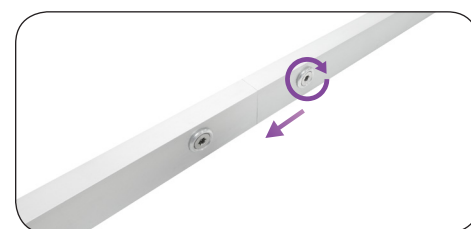

c. Then slide the other extrusion onto split connector. Make sure extrusions are flush and tighten the screw to secure connection.

Next - Build the Top Half

1. Locate the Top and Side Extrusions:

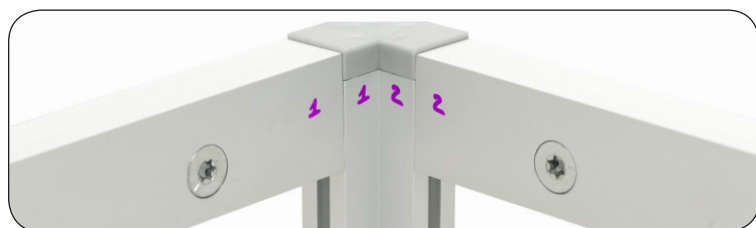

a. See colored numbers on each extrusion piece. Match like colored numbers together. (e.g. 3-3, 4-4).

2. Connect Top Extrusions:

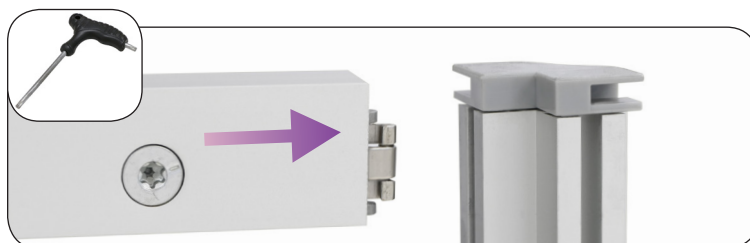

b. Connect top extrusions together and use **torx key** to tighten.

Extra Step: Make and Attach Support Strut - FOR FRAMES 7 FT or WIDER or CUSTOM CUT

1. Locate the 2 Aspen 40C Extrusions & Center Connector:



a. Note: These extrusions are slender and smooth on both sides with 1 hole on each end.

b. Remove screws from Center Connector.

c. Insert Center Connector and align holes with holes on extrusion.

d. Repeat to connect other extrusion to make one long piece.

2. Attach Support Strut to Frame:

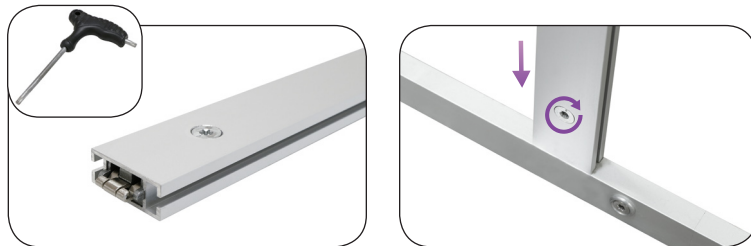

a. End Lock is already attached to opposite ends of Support Strut.

b. Find marked label on the side of the extrusions.

c. Align Support Strut within marked lines, and insert End Lock into top and bottom grooves of frame.

d. Tighten screws with **torx key** to secure connection.

Optional Step: Edge Lights Attachment

1. Attach Lights on Extrusion:

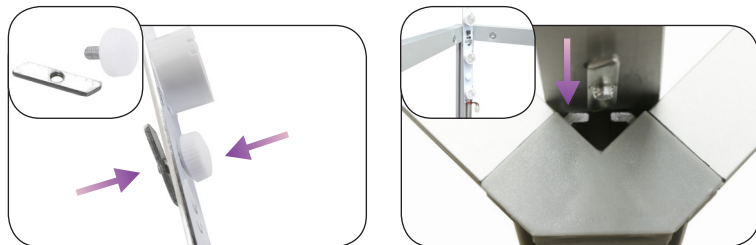

a. Insert screws and base together onto the edge lights.

b. Attach lights by inserting base of screw into the groove on the frame.

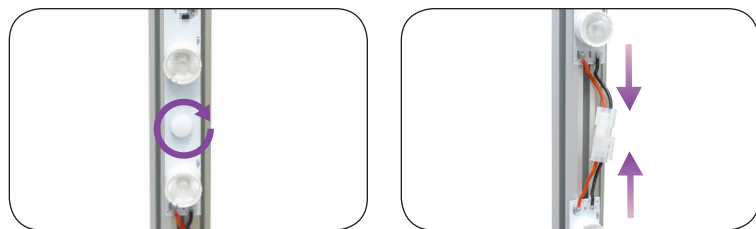

c. Turn knob clockwise to secure.

d. Connect male and female connectors together to form a string of lights.

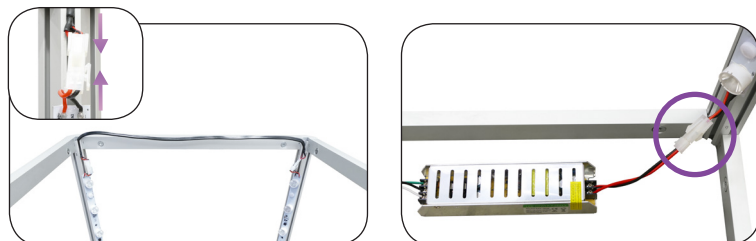

e. Connect other edge lights together with black jumper cable.

f. Then connect edge lights with transformer together.

Last Step - Place Acrylic Countertop

1. Locate Acrylic Squares:

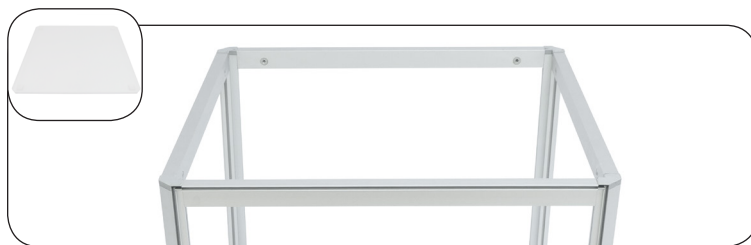

a. Place acrylic countertop onto top of frame.

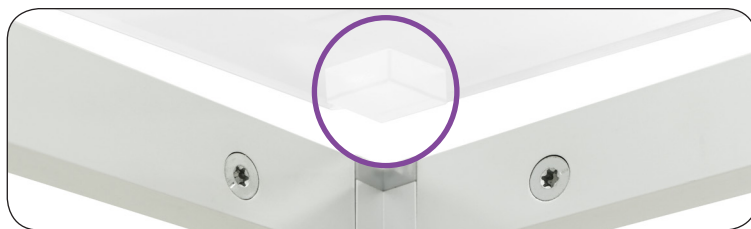

b. Notice acrylic squares underneath countertop.



c. Align with corners of frame.