

Hero

Hero is the premier heavy-duty portable folding panel kit. With both tabletop and exhibit height options, the Hero comes in a wide variety of configurations. Hero locks together seamlessly and offers concealed hinges, lightweight durability and superb craftsmanship. Panels are constructed of an ultra light core material and covered on both sides in fabric.



Features and Benefits

- Durable premium seamless exhibit panel kits
- Convenience of folding panels with elegant, seamless panel construction
- Concealed hinges
- Unique 2" radius curved ends lend a polished appearance
- Full height units can also be used as two tabletop units
- Available in a variety of fabric color options
- Shown with optional detachable graphics (cover)

Display Dimensions

See pages 1 & 2

Alcove Table Top: 23.250"d x 63.75"w (hinged) 590.55mm d x 1619.26mm w
Peninsula Table Top: 47"d x 21.75"w 1193.8mm d x 552.45mm w

Additional Information

Shipping Weight & Dimensions:

Weight: See page 1 & 2

Dimensions: OCH case, 50"x28"x12"

Graphics:

Detachables Available: 22 mil opaque PVC

Main Panel: 21.75"w x 47.125"h velcro applied

Header 1 (H03, H04, H15-1): 44.875"w x 11.71875"h

Header 2 (H16-H20): 65.625"w x 11.71875"h

Header 3 (H08, H10): 75"w x 11.71875"h

All headers mounted 1st surface, 1/8" milk plex

H02-1
58" w x 47.5" h x 17" d
25 lbs
1 case

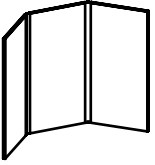

H02-2
63" w x 47.5" h x 18" d
30 lbs
1 case

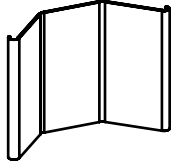

H03
58" w x 47.5" h x 17" d
30 lbs
1 case

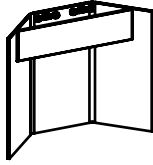

H04
63" w x 47.5" h x 18" d
39 lbs
1 case

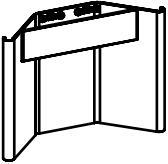

H05
83" w x 47.5" h x 17" d
37 lbs
1 case

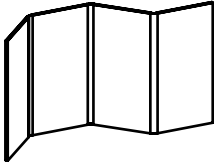

H08
88" w x 47.5" h x 18" d
55 lbs
1 case

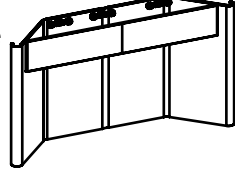

H09
63" w x 94.75" h x 18" d
60 lbs
1 case

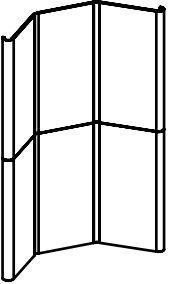

H10
88" w x 94.75" h x 18" d
96 lbs
2 cases

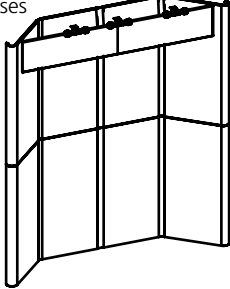

H14
110" w x 94.75" h x 18" d
95 lbs
3 cases

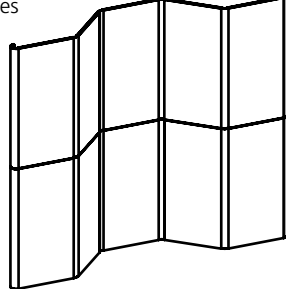

H15-1
110" w x 94.75" h x 78" d
104 lbs
3 cases

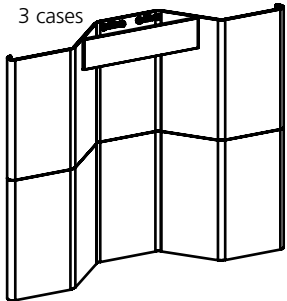

H16
117.25" w x 94.75" h x 65" d
227 lbs
3 cases

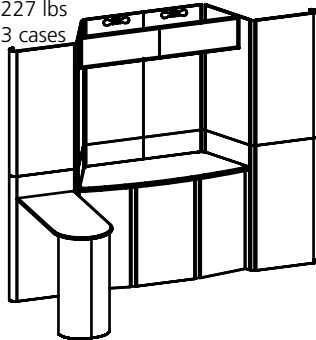

H17
117.25" w x 94.75" h x 18" d
205 lbs
3 cases

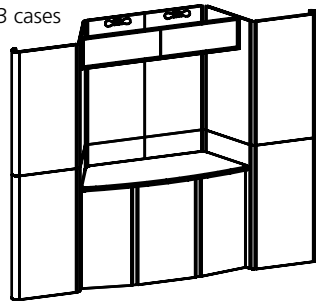

H18
230.25" w x 94.75" h x 18" d
410 lbs
6 cases

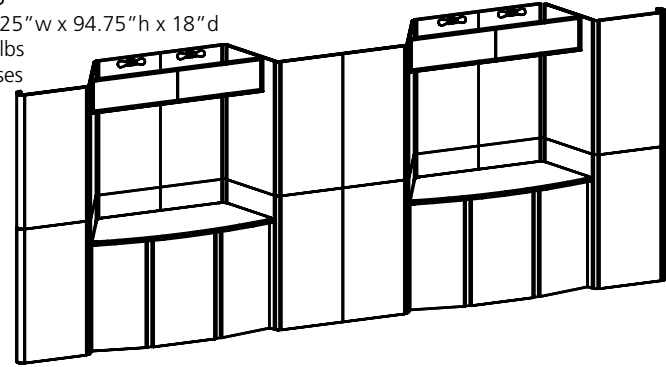

H19
230.25" w x 94.75" h x 65" d
432 lbs
6 cases

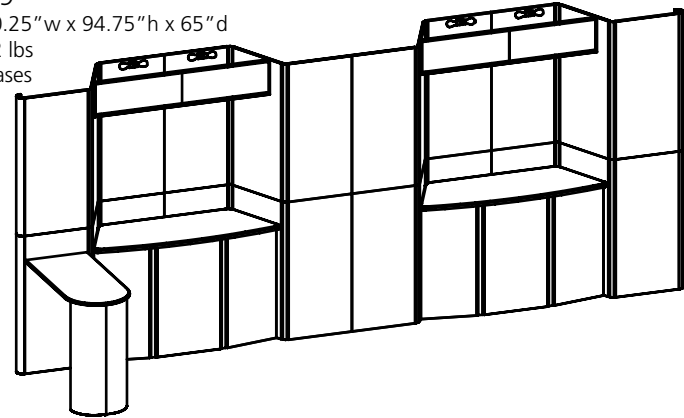

H20
230.25" w x 94.75" h x 65" d
476 lbs
7 cases



extend panels
ALL KITS

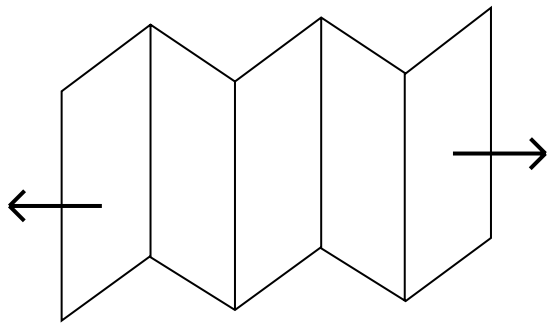

stack panels
H09-H20

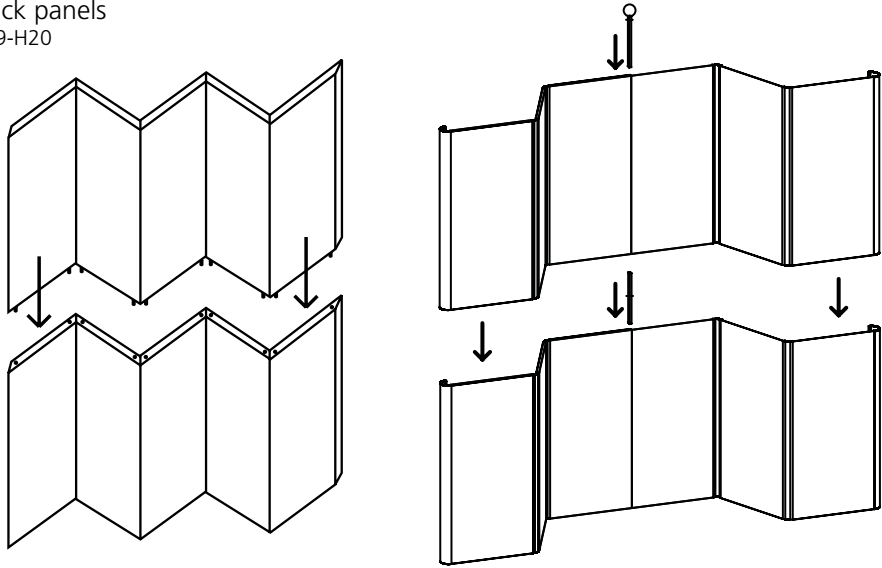

add endcaps
H02-2, H04, H08-H20

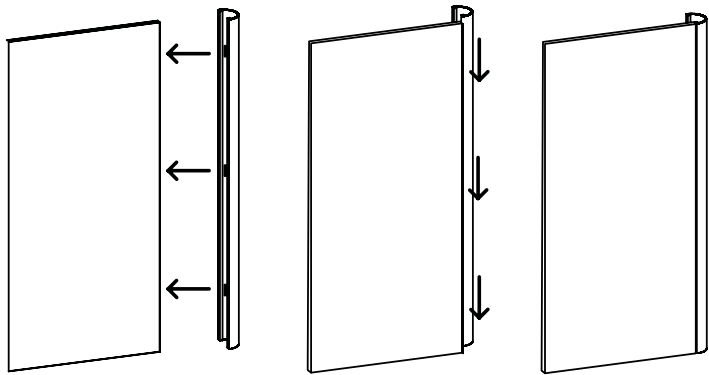

assemble peninsula table
H16, H19-H20

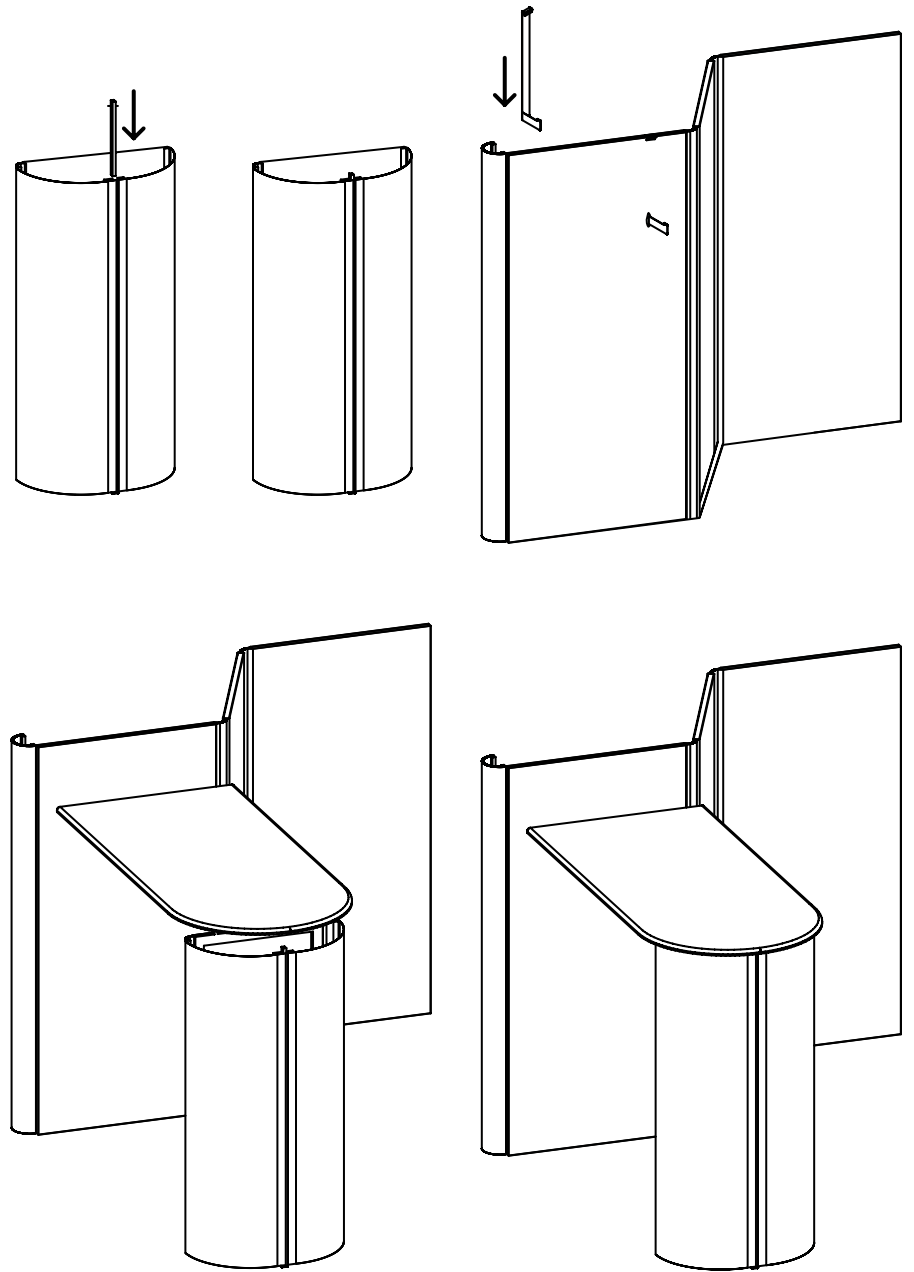

assemble alcove table
H16-H20

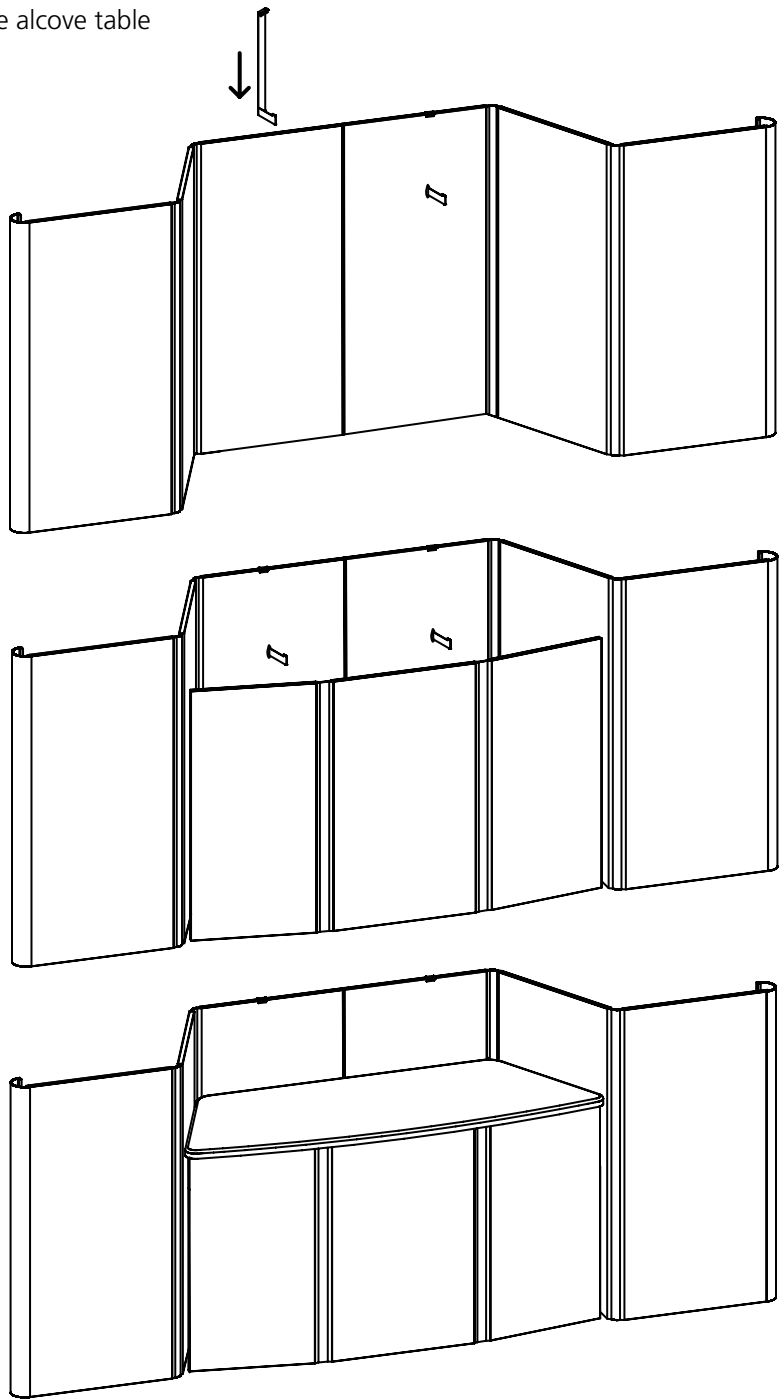

attach lights
H03-H04, H08, H10, H15-H20

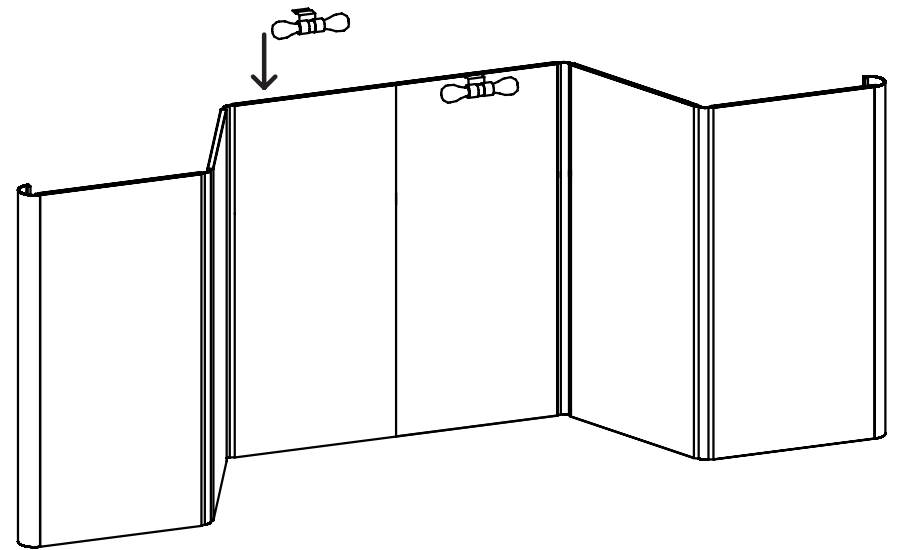

attach header
H03-H04, H08, H10, H15-H20

